



SPORTING EVENTS AT THE WOODMAN'S CENTER

PARTNERING WITH WOODMAN'S SPORTS AND CONVENTION CENTER

Opening in Fall 2025, the Woodman's Sports & Convention Center in Janesville, Wisconsin, is poised to be a versatile venue for corporate events, conferences, and trade shows. This modern facility encompasses approximately 140,000 square feet, offering flexible spaces to suit various event needs.

HIGHLIGHTS INCLUDE:

ROBERT & DELORES KENNEDY CONVENTION CENTER: A 25,800-square-foot space designed for trade shows, conventions, expos, banquets, and community events.

MULTIPURPOSE ARENA: A 23,000-square-foot adaptable space that can transition between ice, hardcourt, or turf, with seating for 250 spectators.

MERCYHEALTH ARENA: Arena suitable for large-scale presentations and gatherings with stadium seating for 1,500.

woodmanscenter.com



 **WOODMAN'S**
SPORTS & CONVENTION CENTER

VENUE OVERVIEW

The Woodman's Sports & Convention Center offers a comprehensive array of amenities designed to provide an exceptional experience for all attendees. The facility features well-appointed locker rooms, breakout meeting rooms, a training room, concessions, and administrative spaces. Attendees will benefit from complimentary Wi-Fi and ample on-site parking accommodating over 2,000 vehicles. Strategically located just minutes from Interstate 39/90 and adjacent to Uptown Janesville shopping center, the center provides convenient access to a variety of hotels, restaurants, and retail outlets, ensuring a seamless and enjoyable visit for athletes, spectators, and event participants alike.

With modern amenities, flexible spaces, and a commitment to excellence, the Woodman's Center is equipped to accommodate events of all sizes, ensuring a memorable experience for all attendees.

The Woodman's Sports & Convention Center is managed by Sports Facilities Companies (SFC), whose mission is to improve the health and economic vitality of the communities they serve. With extensive experience operating leading sports and event venues nationwide, SFC ensures the Center is run with excellence, community focus, and long-term impact in mind.





MERCYHEALTH ARENA

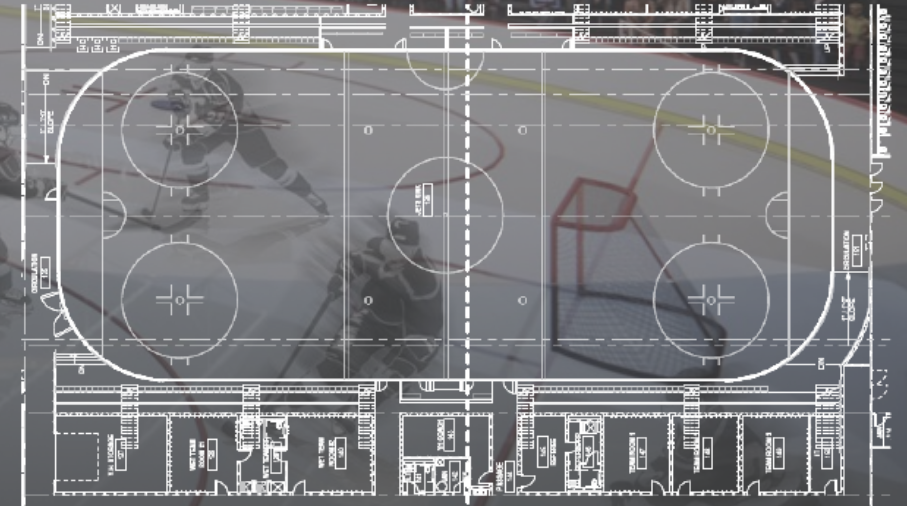

- Year-round ice for hockey, skating, and other activities with seating for 1,500 spectators

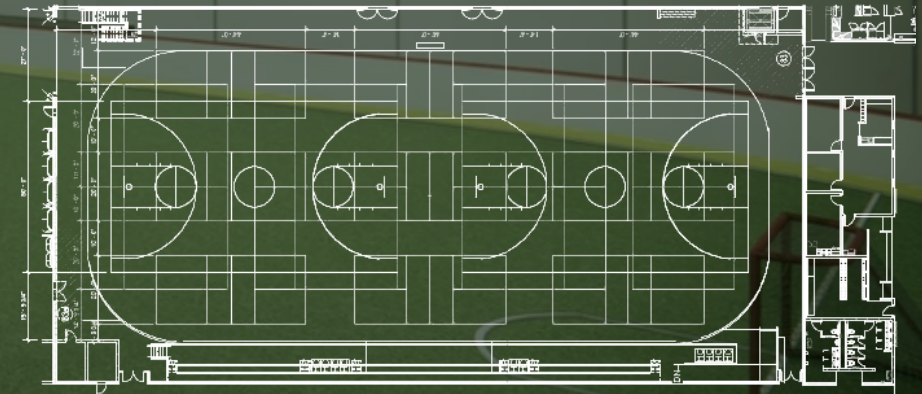

- 23,000 square feet
- Seasonally convertible to space for conferences and events
- Seating for 864 at round tables, or 1,554 theater seating, or 82 trade show booths
- Adjustable space for multi-sport use with seating for 250 spectators

MULTI-PURPOSE ARENA

ROBERT & DELORES KENNEDY CONVENTION CENTER

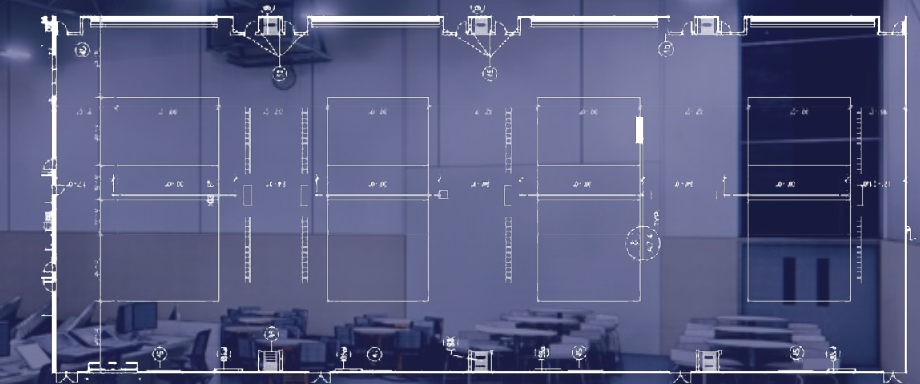

- 25,800 square feet
- Space for trade shows, conventions, expos, banquets, and community events
- Athletic use for basketball, volleyball, pickleball, open gym, turf and more
- Seating for 1,000 at round tables, 1800 theater seating, or 110 trade show booths

SPORTS SPACES



COURTS	MAX	MULTI-USE	MULTI-PURPOSE ARENA (SEASONAL ICE)	MAIN ARENA (YEAR-ROUND ICE)
Basketball	6	4	2	-
Volleyball	8	4	4	-
Pickleball	21	12	9	-
Soccer	1	-	1	-
Hockey	2	-	1	1
Ice Skating	2	-	1	1

woodmanscenter.com

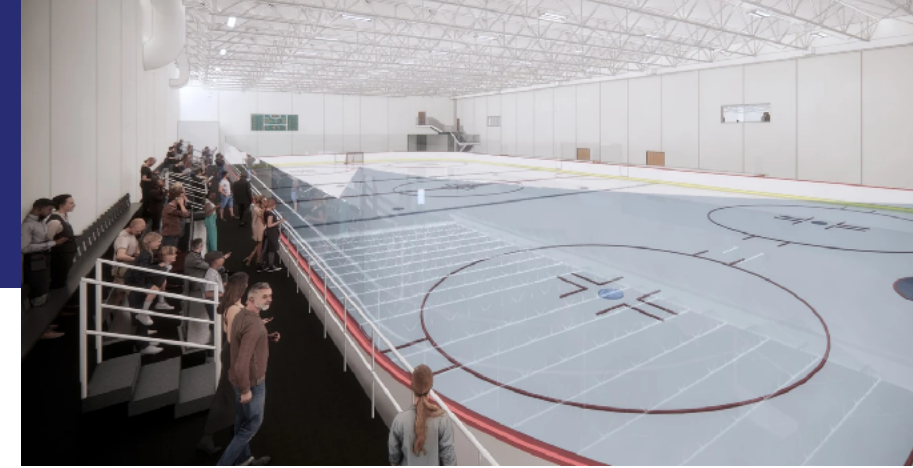

SPORTS SPACES (LAYOUTS)

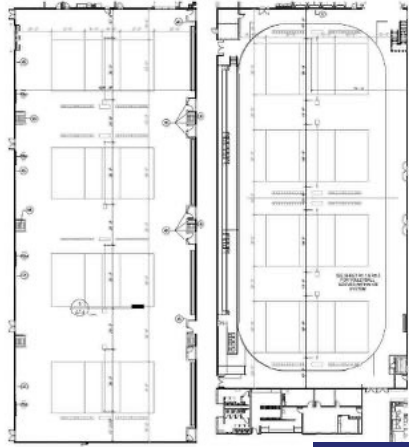

VOLLEYBALL

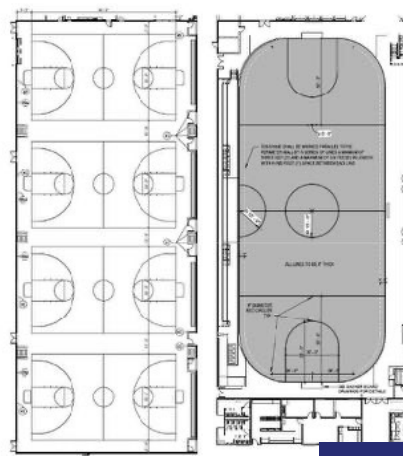

INDOOR TURF

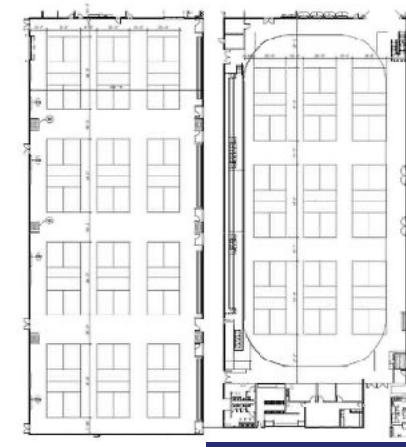

PICKLEBALL

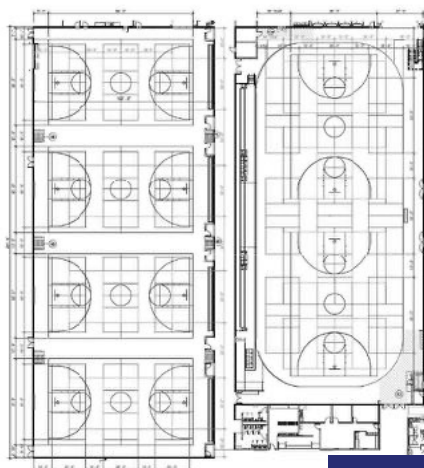

LINE OVERLAY

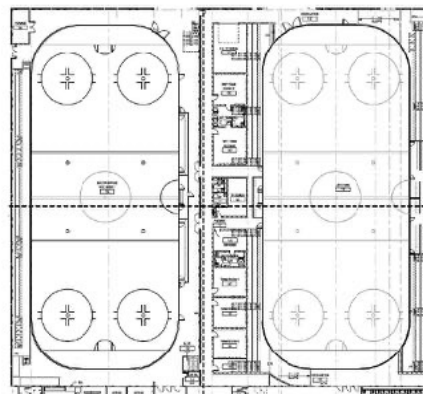

ICE ARENAS

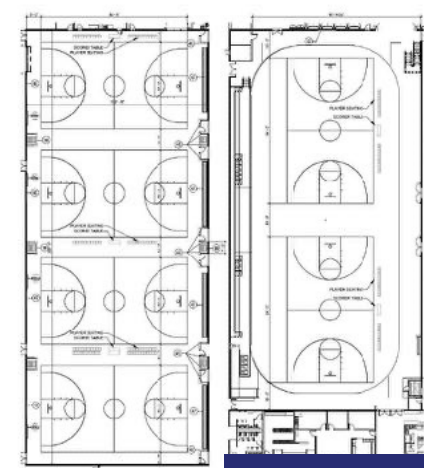

BASKETBALL

ENHANCE YOUR EVENT WITH OUR COMPREHENSIVE SUPPORT SERVICES

In addition to venue rental, we offer a comprehensive suite of optional services to enhance your event experience at an additional fee.

CATERING SERVICES:

Our catering partners offer customized menus tailored to your event's needs, ranging from full-course meals to light refreshments and bar services.

TECHNICAL SUPPORT:

Audiovisual setups by qualified staff available to assist to deliver a seamless and professional presentation throughout your event.

SECURITY AND STAFFING:

Trained personnel, including security staff and event coordinators, to ensure smooth operations and guest safety throughout your event.

EVENT INFRASTRUCTURE:

Access specialized staging, portable bleachers, chairs, and tables to accommodate various event formats and sizes.

PRINTING SERVICES:

High-volume printing services for programs, signage, and other event materials to maintain a cohesive and professional look.

TRANSPORTATION ARRANGEMENTS:

Facilitate guest travel with organized bus services from nearby airports, ensuring timely and comfortable arrivals.



WHY CHOOSE JANESVILLE FOR YOUR EVENT AT THE WOODMAN'S SPORTS & CONVENTION CENTER...

Janesville, Wisconsin, offers a unique blend of small-town charm and modern amenities, making it an exceptional choice for hosting your event at the Woodman's Sports & Convention Center.

FULL SPECTRUM PHOTOGRAPHY

With beautiful parks, a lively downtown, and easy access from I-39/90, visitors enjoy a welcoming, well-connected experience—perfect for athletes, spectators, and event organizers alike.

JANESVILLE, WISCONSIN

JANESVILLE AREA



Convention & Visitors Bureau

To further enhance your event experience, the Janesville Area Convention & Visitors Bureau (JACVB) offers a range of services designed to support and promote your event.

Their experienced team understands what's important to event organizers and can assist with every aspect of complementary event planning, from venue selection and event promotions to logistics, making the process hassle-free while saving you time and money.

PRE-EVENT CONSULTATION

- Provide detailed venue and sports facility information
- Secure proposals from venues and hotels
- Assist with RFP preparation and the bid process
- Arrange site inspection tours for venues and accommodations

PROGRAM ASSISTANCE

- Connect you with local vendors, entertainment, and speakers
- Assist with grants and promotions your event is eligible for
- Arrange hotel room blocks to keep your teams together
- Arrange unique group activities, including tours and attractions

PUBLIC RELATIONS

- Assist with media relations to promote your event
- Arrange official welcomes and proclamations to make your event memorable

REGISTRATION SUPPORT

- Offer welcome bags with area information and exclusive coupons
- Provide maps with venue and hotel locations
- Create customized name badges and event materials
- Deliver materials to your venue
- Provide volunteers for event assistance

WE'RE HERE TO HELP BRING YOUR EVENT TO LIFE — AND PROUD TO PARTNER WITH THE JANESVILLE AREA CONVENTION & VISITORS BUREAU TO MAKE YOUR PLANNING EXPERIENCE SEAMLESS AND SUCCESSFUL.

Visit the Janesville Area CVB online to learn more about Janesville and how they can assist in making your event a success.

Photo Courtesy of FULL SPECTRUM PHOTOGRAPHY



**LET'S MAKE YOUR NEXT EVENT
UNFORGETTABLE.**

